

Technical requirements

1. The parts and components (including outsourcing parts and outsourcing parts) that enter the assembly All must have the certificate of conformity of the inspection department before assembly.
2. The parts must be cleaned and washed before assembly, no burrs, Flying edge, oxidized skin, rust, chips, oil, colorants and dust.
3. Before assembly should be zero, parts of the main with the size, especially interference with the size and accuracy of the review. Dimensions and related accuracy for review.
4. During the assembly process, the parts are not allowed to be knocked, touched, scratched and rusted.
5. After assembly, carry out air tightness test before packaging and storage.

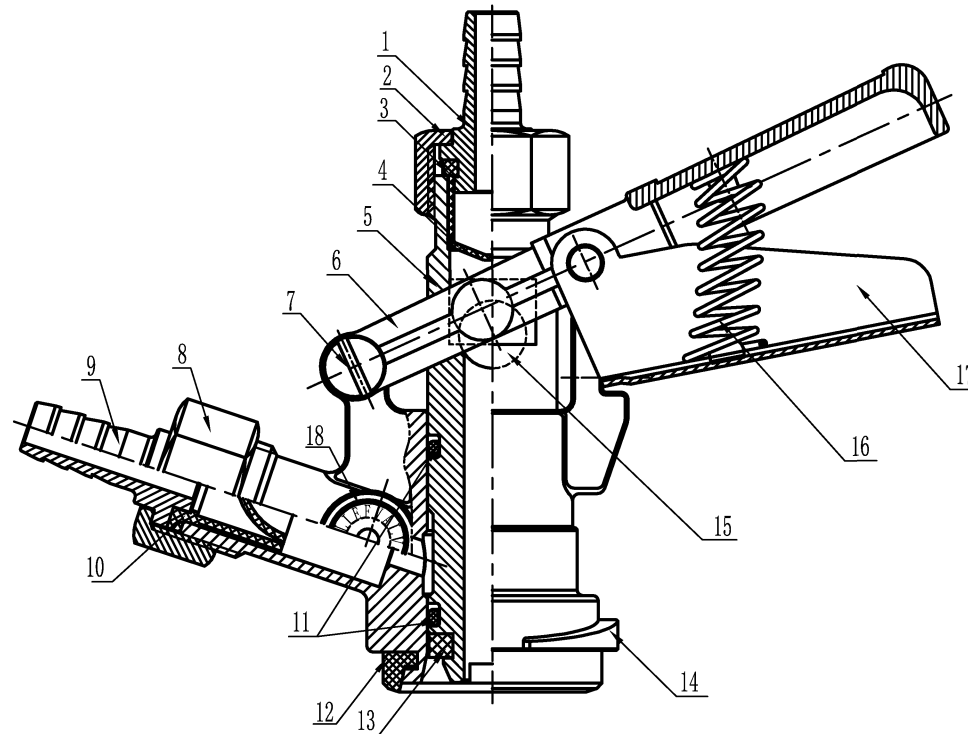

	18	FPQ-SX-06-18	Pressure relief valve-1	1	0Cr18Ni9 (SUS304)	
	17	FPQ-SX-06-17	Spring pressure plate	1	0Cr18Ni9 (SUS304)	
Shared (General) Parts Register	16	FPQ-SX-06-16	Taper Spring	1	0Cr18Ni9 (SUS304)	
Design	15	FPQ-SX-06-15	Non-return valve	1	0Cr18Ni9 (SUS304)	
	14	FPQ-SX-06-14	Body	1	0Cr18Ni9 (SUS304)	
	13	FPQ-SX-06-13	Guide ring-2	1	0Cr18Ni9 (SUS304)	
Check	12	FPQ-SX-06-12	Special-shaped sealing ring	1	EPDM	
	11	FPQ-SX-06-11	O-ring	2	EPDM	
General No. of original drawing	10	FPQ-SX-06-10	CO <sub>2</sub> safety valve	1	EPDM	
	9	FPQ-SX-06-9	CO <sub>2</sub> connection	1	0Cr18Ni9 (SUS304)	
	8	FPQ-SX-06-8	Nuts-2	1	0Cr18Ni9 (SUS304)	
General No. of drawing	7	FPQ-SX-06-7	Locking pin	1	0Cr18Ni9 (SUS304)	
	6	FPQ-SX-06-6	Handle	1	0Cr18Ni9 (SUS304)	
	5	FPQ-SX-06-5	Probe	1	0Cr18Ni9 (SUS304)	
Signature	4	FPQ-SX-06-4	Ball retainer	1	PA66	
	3	FPQ-SX-06-3	Guide ring-1	1	EPDM	
Date	2	FPQ-SX-06-2	Nuts-1	1	0Cr18Ni9 (SUS304)	
	1	FPQ-SX-06-1	Beer connection	1	0Cr18Ni9 (SUS304)	
	No	Code No	Name	QTY	Material	Remarks

						Assembly Drawing				Dispro Europa, S. L. DisproBeer		
Mark	Revision	Area	File No	Sign	Date	Phase Marker		QTY	Weight	Scale	S Dispenser	
Design			Standard								FPQ-SX-06	
Calculation			Discussion									
Inspection												
Procedure			Sign			Total 24 page		The 1 page				